

## REMOVAL AND INSTALLATION (Continued)

REMOVAL AND INSTALLATION (Continued)

## Air Inlet Duct and Blower Housing Assembly

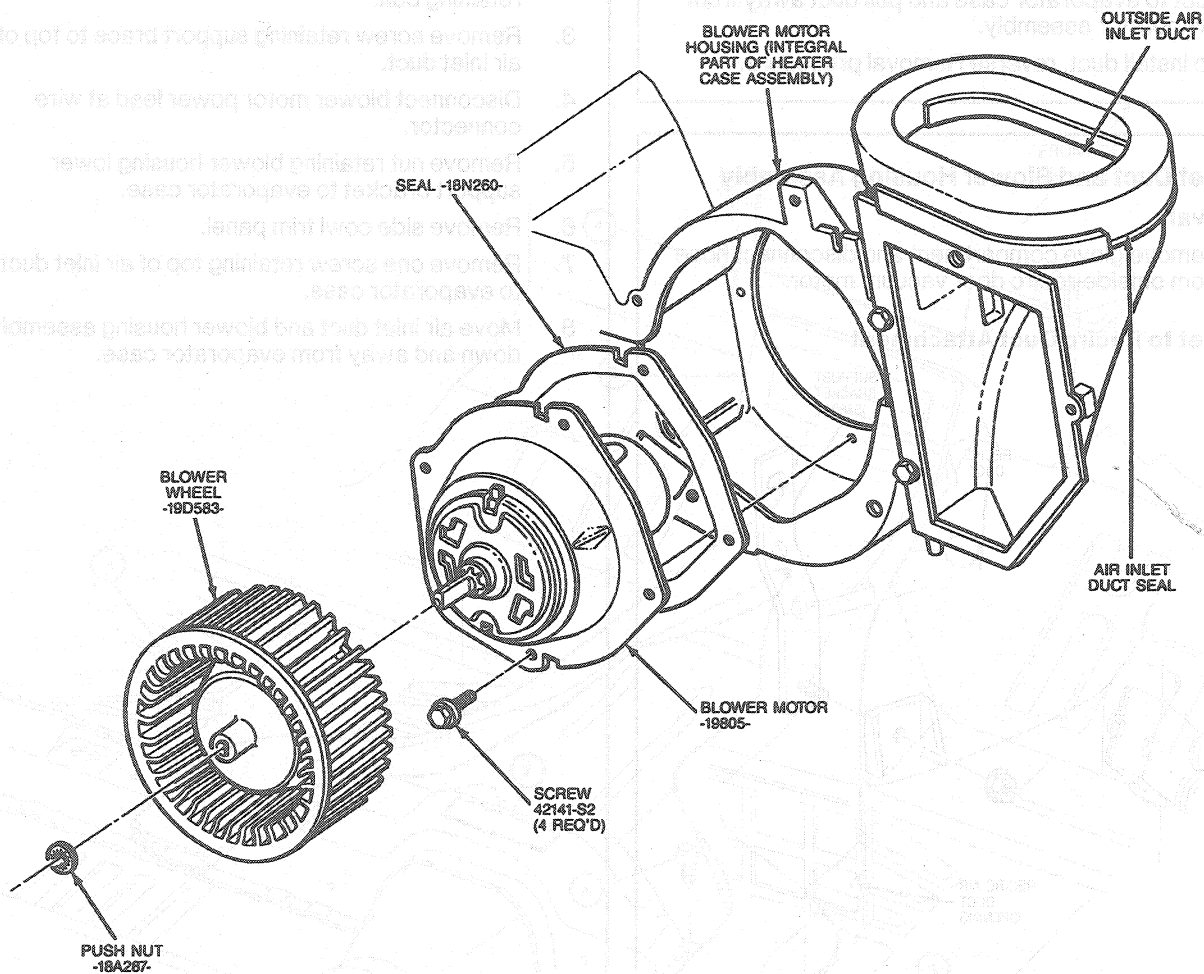

CCL 2804-C

## Installation

1. Tape blower motor power lead to air inlet duct to keep wire away from blower outlet during installation.
2. Position air inlet duct and blower housing assembly to evaporator case, inserting flange at top of blower outlet into opening in evaporator case. Slide blower housing lower bracket over stud and install retaining nut. Ensure blower wire is routed to RH side of evaporator case.
3. Install screw retaining air inlet duct to evaporator case.
4. Hold outside-recirc door open and rotate blower wheel to ensure it rotates freely. If an interference exists, remove blower motor and wheel and correct condition.
5. Connect blower motor power lead to harness at connector.
6. Install air inlet duct-to-cowl support brace retaining screw.

7. Connect vacuum hose to outside-recirc door vacuum motor and install glove compartment.
8. Install instrument panel lower RH side retaining bolt. Then, install RH cowl side trim panel.

## Panel/Floor Door Vacuum Motor

## Removal

1. Disconnect battery ground cable.
2. Remove instrument panel.
3. Depress tabs and disconnect vacuum motor arm from door shaft.
4. Remove two screws retaining vacuum motor to mounting bracket.
5. Remove vacuum motor from mounting bracket and disconnect vacuum hose.