

**DISASSEMBLY AND ASSEMBLY (Continued)**

8. In the side of the pump housing is a small hole. Through this hole, insert a small drift or suitable tool, and push inward on valve cover retaining ring. While applying inward pressure on retaining ring, place screwdriver under edge of retaining ring. Remove the ring.

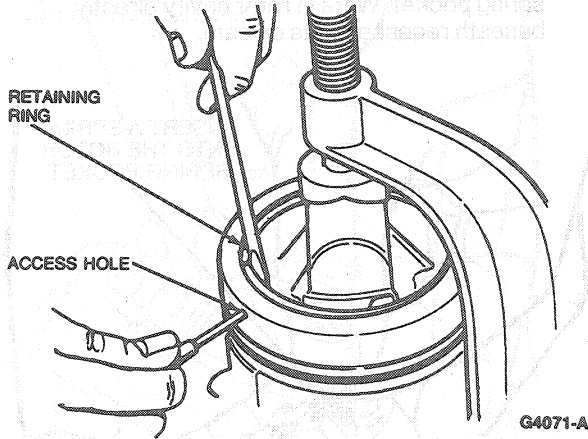

9. Loosen C-clamp, upper compressor plate and pump assembly.
10. Remove pump valve cover. Discard O-ring seal.
11. Push on rotor shaft to remove shaft, upper plate, rotating group assembly and two dowel pins.

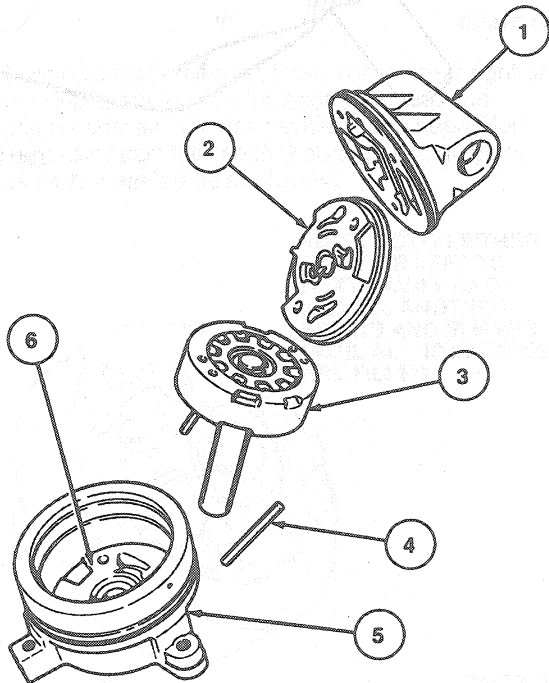

Item	Part Number	Description
1	3C544	Valve Cover Assy
2	3D590	Lower Plate
3	3D607	Cam and Rotor Assy
4	387579-S	Dowl Pin (2 Req'd)
5	3D643	Pump Housing Plate
6	3A645	Upper Plate

TG4173B

12. The lower plate and Belleville spring will remain in pump housing. To remove, place pump housing on a flat surface. Raise slightly and strike housing against flat surface until lower plate and Belleville spring fall out. Discard O-ring seals.

