

REMOVAL AND INSTALLATION (Continued)

Installation

1. Install new connector if damage was found. Install new clip, insert clip into any two adjacent openings with triangular portion pointing away from fitting opening. Install clip to fully engage body (legs of hairpin clip locked on outside of body). Piloting with an index finger is necessary.
2. Before installing fitting on tube, wipe tube end with a clean cloth. Inspect inside of fitting to ensure it is free of dirt and/or obstructions. Apply a light coat of engine oil to the tube end for ease of assembly.
3. To install fitting onto tube, align fitting and tube axially and push fitting onto tube end. When fitting is engaged, a definite click will be heard. Pull on fitting to ensure it is fully engaged.

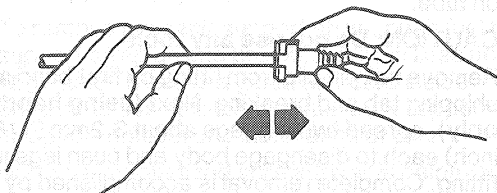
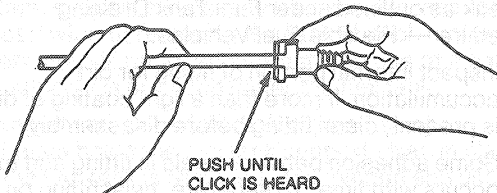
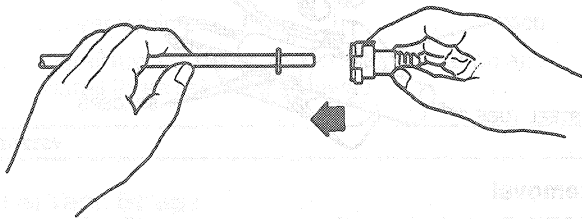

V4141-A

Fuel Vapor Tube Push Connect Removal

No removal tool is required for the nylon fuel vapor connectors used on the Flexible Fuel vehicles. These connectors can be disconnected by squeezing the connector and pulling it off the tube end.

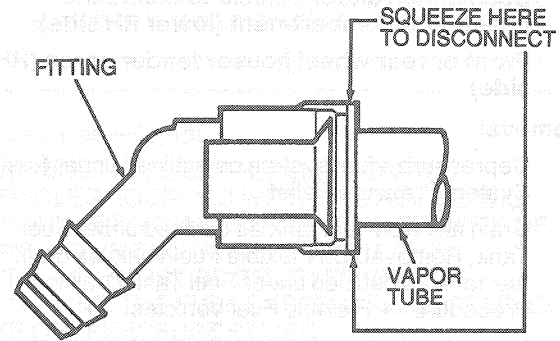

V8614-A

Spring Lock Coupling

Tools Required:

- Fuel Line Disconnect Tool 3/8 Inch (Yellow) D87L-9280-A
- Fuel Line Disconnect Tool 1/2 Inch (Green) D87L-9280-A

The spring lock coupling is a fuel line coupling held together by a garter spring inside a circular cage. When the coupling is connected together, the flared end of the female fitting slips behind the garter spring inside the cage of the male fitting. The garter spring and cage then prevent the flared end of the female fitting from pulling out of the cage. As a redundant locking feature, a horseshoe shaped retaining clip is incorporated to improve the retaining reliability of the spring lock coupling.

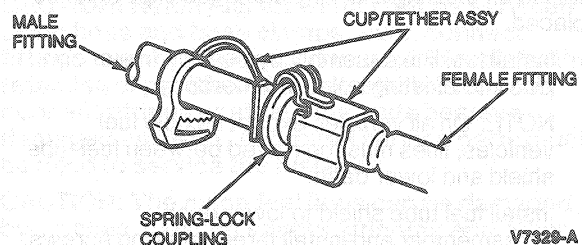

V7329-A

Removal

1. Release fuel system pressure as outlined under Fuel System Pressure Relief.
2. Remove retaining clip from spring lock coupling by hand only. Do not use any sharp tool or screwdriver as it may damage the spring lock coupling.
3. Twist fitting to free it from any adhesion at the O-ring seals.
4. Fit Fuel Line Disconnect Tool D87L-9280-A (3/8 inch) (Yellow) or D87L-9280-B (1/2 inch) (Green) or equivalents to coupling.
5. Close tool and push into open side of cage to expand garter spring and release female fitting.
6. After garter spring is expanded, pull fittings apart.