

## REMOVAL AND INSTALLATION (Continued)

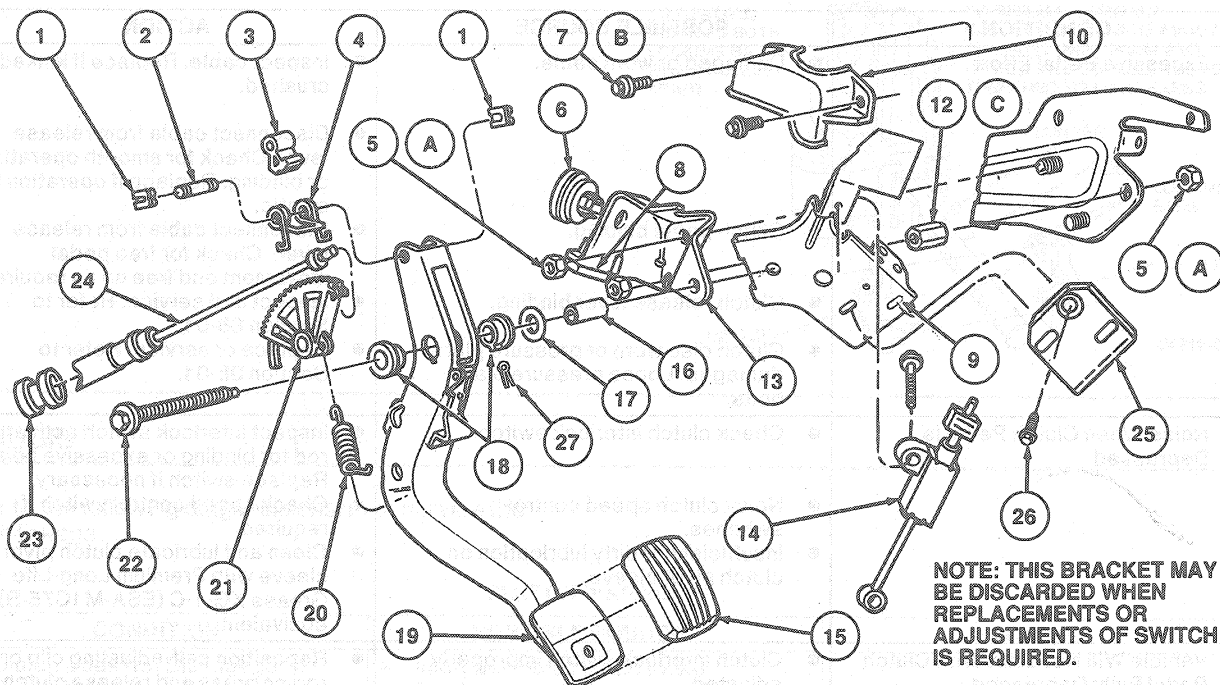

NOTE: THIS BRACKET MAY BE DISCARDED WHEN REPLACEMENTS OR ADJUSTMENTS OF SWITCH IS REQUIRED.

C5445-G

Item	Part Number	Description
1	N801406-S2	Retaining Clip (2 Req'd)
2	7L586	Pin
3	7L584	Pawl
4	7L585	Pawl Tension Spring
5A	382802-S2	Nut (3 Req'd)
6	7C511	Isolator
7B	N601957	Screw (2 Req'd)
8	7B520	Stop
9	9D816	Speed Control Release Switch Mounting Bracket
10	7C521	Shield
11	7B517	Clutch Mounting Plate
12C	390387-S36D	Spacer Nut
13	7K607	Clutch Pedal Stop Bracket
14	11A152	Switch
15	2457	Pad
16	N803233-S	Pivot Sleeve

Item	Part Number	Description
17	7512	Spring Washer
18	7A578	Pivot Bushings (2 Req'd)
19	7519	Clutch Pedal
20	7K576	Gear Quadrant Tension Spring
21	7L583	Gear Quadrant
22	57110-S2	Pivot Bolt
23	N804705-S	Dash Panel Grommet
24	7K553	Clutch Cable
25	—	Bracket
26	N803509-S2	Bolt
27	74273-S2	Clip
A		Tighten to 20-34 N·m (15-25 Lb·Ft)
B		Tighten to 8-12 N·m (7-106 Lb·In)
C		Tighten to 28-45 N·m (21-33 Lb·Ft)

(Continued)

**Removal**

1. Disconnect battery ground cable.
2. Unlatch fuse panel.

3. Position clutch shield away from mounting plate bracket by removing rear retaining screw. Loosen front retaining screw located near toe board, and rotate shield out of way. Secure by snugging up front screw. (Rear retaining screw is nearest instrument panel.)

**CAUTION:** Do not allow quadrant to snap back.