

## REMOVAL AND INSTALLATION (Continued)

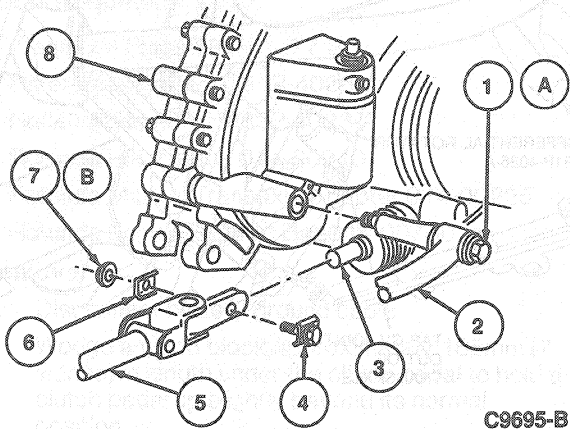

C9695-B

Item	Part Number	Description
1A	N601426	MHM 12 X 1.75
2	7400	Stabilizer Shaft
3	7L267	Shift Shaft
4	7K104	Clamp
5	7202	Shift Rod
6	7K105	Clamp
7B	N620480-S2	Nut M6 X 1.00
8	—	Transaxle Assy
A	—	Tighten to 47-63 N-m (35-46 Lb-Ft)
B	—	Tighten to 9-12 N-m (80-106 Lb-In)

26. Remove engine mount bolts.
27. Position jacks under body mount positions and remove four bolts, lower subframe and position out of the way.
28. Remove starter motor assembly.

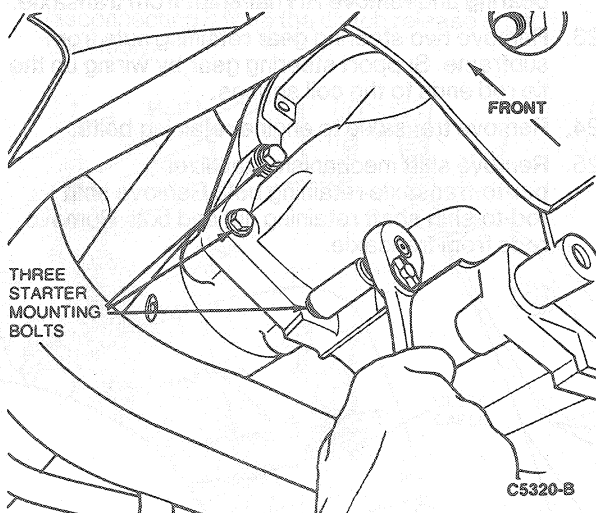

C5320-B

29. Remove LH engine vibration dampener lower bracket.

30. Using a small screwdriver, remove the backup lamp switch connector from the transaxle backup lamp switch, located on top of the transaxle.

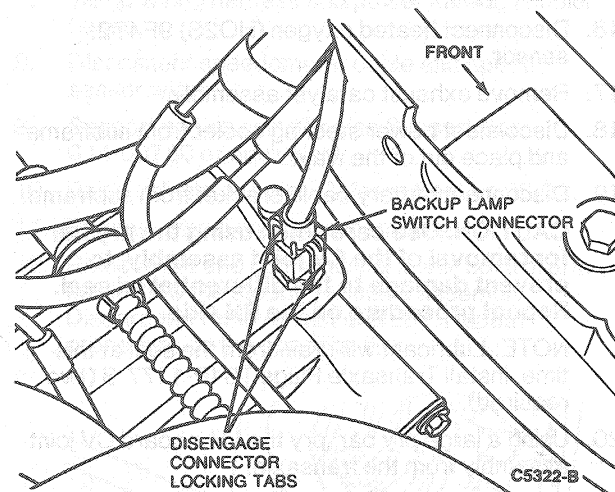

C5322-B

31. Remove backup lamp switch connector.
32. Position Rotunda Hi-Lift Jack 014-00210 and Rotunda Manual Transaxle Adapter 014-00225, or equivalent, under the transaxle.

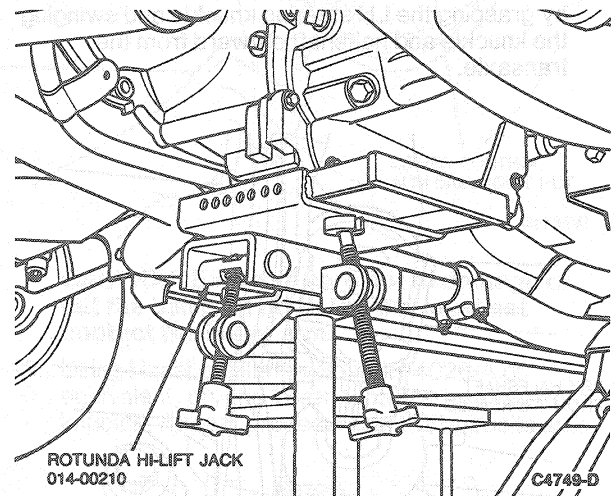

33. Lower the transmission jack and transaxle adapter.  
**WARNING: THE TRANSAXLE CASE CASTING MAY HAVE SHARP EDGES. WEAR PROTECTIVE GLOVES WHEN HANDLING THE TRANSAXLE ASSEMBLY.**
34. Remove the transaxle from the engine and lower it from the vehicle.

**Installation**

**NOTE:** Make sure that the transaxle assembly is flush with the rear face of the engine prior to installation of the retaining bolts.