

REMOVAL AND INSTALLATION (Continued)

Installation

1. Slide master cylinder onto booster studs. Ensure seal is in place in groove on master cylinder and install two retaining nuts. Tighten nuts to 21-29 N·m (16-21 lb-ft).
2. Place booster and master cylinder assembly in position on dash.
3. Inside passenger compartment, install booster push rod and bushing on brake pedal pin with head of bushing away from pedal. Secure booster to dash panel with self-locking nuts. Tighten nuts to 21-29 N·m (16-21 lb-ft).

CAUTION: Use care not to bend or deform switch.

4. Position stoplamp switch so that it straddles booster push rod with switch slot toward pedal blade and hole just clearing pin. Slide switch completely onto pin.
5. Install outer nylon washer on pin and secure all parts to pin with hairpin retainer. Make sure retainer is fully installed and locked over pedal pin. Install stoplamp switch wiring connector.
6. Install pedal travel switch as outlined. Adjust switch as outlined under Adjustments.
7. Connect brake tubes to master cylinder and tighten to 15-20 N·m (11-15 lb-ft). Connect HCU supply hose to reservoir.
8. Connect manifold vacuum hose to booster check valve and electrical connector to master cylinder reservoir cap.
9. Bleed brake system as outlined.

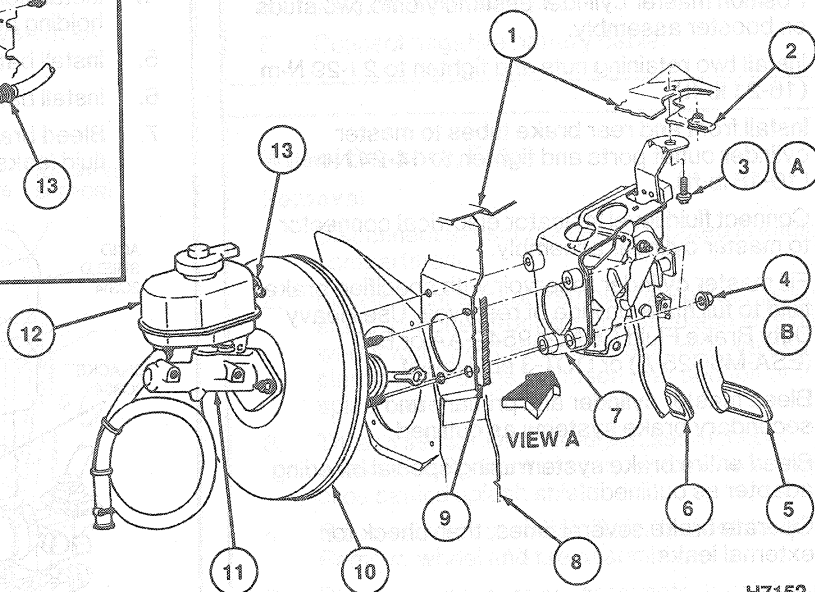
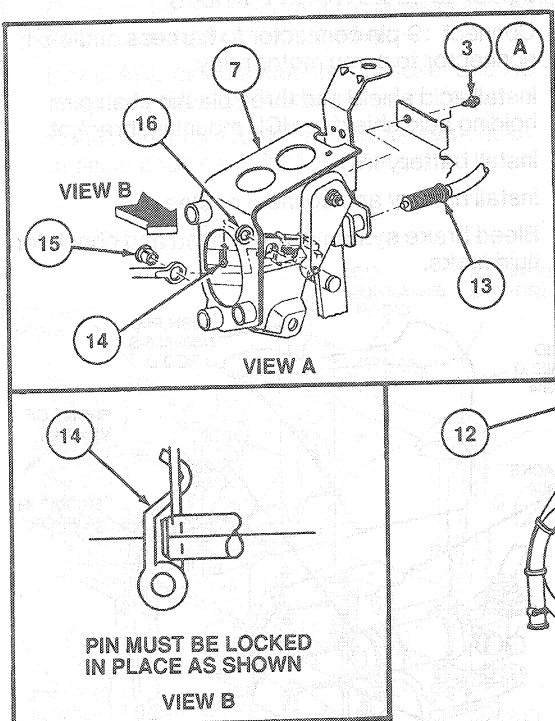

H7152-B

Item	Part Number	Description
1	—	Cowl
2	N800538-S100	Nut
3A	N606689-S2	Bolt
4B	N620481-S2	Nut (4 Req'd)
5	—	Brake Pedal (Auto)
6	—	Brake Pedal (Manual)
7	2450	Pedal Bracket Assy
8	—	Dash Panel
9	—	Dash

(Continued)

Item	Part Number	Description
10	2B195	Vacuum Booster
11	2B195	Master Cylinder
12	2B195	Reservoir
13	9C727	Speed Control Valve
14	380699-S100	Pin
15	2A309	Bushing
16	2B129	Spacer
A		Tighten to 16-30 N·m (12-22 Lb·Ft)
B		Tighten to 21-29 N·m (16-21 Lb·Ft)