

DIAGNOSIS AND TESTING (Continued)

The anti-lock brake control module monitors system operation and can store all defined Diagnostic Trouble Codes (DTCs) in its memory. It is important to understand that the ABS module CANNOT recognize some failures, therefore if a condition exists and no DTCs are stored by the ABS module, other diagnostic steps must be followed.

The module cannot store a DTC if there is no power to the module. This condition can be found by using the Quick Check Sheet.

A 20 series code will override any other stored code and will not allow other codes to be output if the failure exists while the on-board diagnostic is being run. If the failure is intermittent or if the code was left in the ABS module due to improper erasing procedures, the code will be output during on-board diagnostic but the next code will also be output.

STAR Tester Connection and Battery Check

1. Turn ignition switch to OFF position.
2. Locate SUPER STAR II Tester connector in engine compartment behind LH shock tower.
NOTE: Only one multi-pin connector is used.
3. Connect SUPER STAR II Tester connector to vehicle connector.

ABS Module

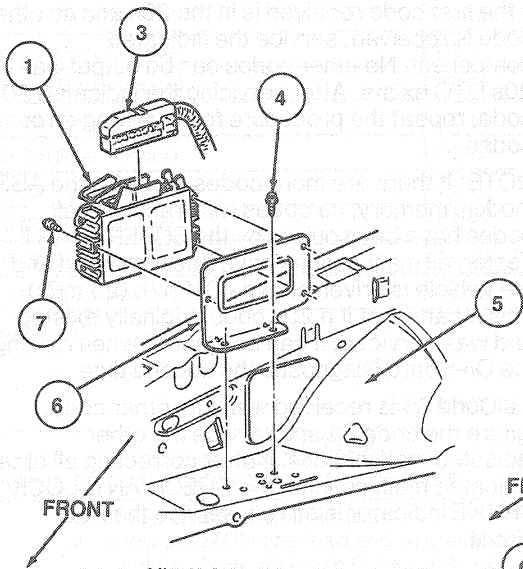

**VIEW A
NON SHO
INSTALLATION ONLY
TAURUS/SABLE**

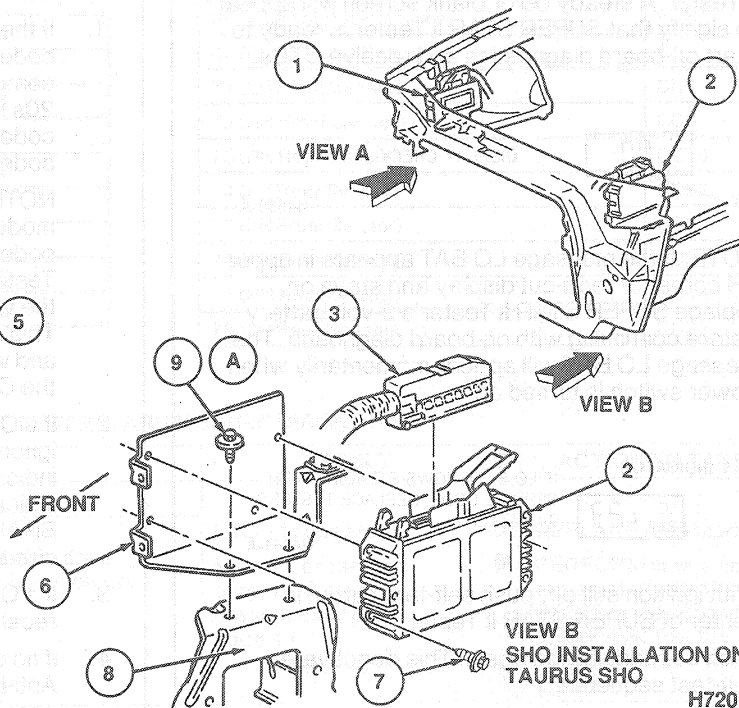

**VIEW B
SHO INSTALLATION ONLY
TAURUS SHO**

H7201-B

Item	Part Number	Description
1	2C219	ABS Module 3.0L and 3.8L
2	2C218	ABS Module SHO Only
3	—	Harness Assy
4	N611194-S2	Bolt (2 Req'd)
5	—	RH Engine Compartment

(Continued)

Item	Part Number	Description
6	2C214	Bracket
7	N805640-S2	Screw (3 Req'd)
8	—	LH Engine Compartment
9A	N800935-S55	Bolt (3 Req'd)
A	—	Tighten to 8-12 N·m (6-8 Lb-Ft)