

REMOVAL AND INSTALLATION (Continued)

3. Remove screw retaining valve bracket to lower suspension arm.
NOTE: The service replacement valve will have a red plastic gauge clip on the valve and must not be removed until installed on the vehicle.
4. Remove two screws retaining valve bracket to underbody and remove assembly.

Installation

1. Ensure rear suspension is in full rebound.
2. Ensure the red plastic gauge clip is in position on the valve and the operating rod lower adjustment screw is loose.
3. Position valve assembly to underbody and install two retaining screws.
4. Position valve lower mounting bracket to lower suspension arm. Install one retaining screw. Tighten to 6-8 N-m (4-6 lb-ft). Ensure the valve adjuster sleeve is resting on lower bracket and install setscrew.
5. Connect four brake tubes in the same position as removed.
6. Bleed rear brakes.
7. Remove red plastic gauge clip and lower vehicle.

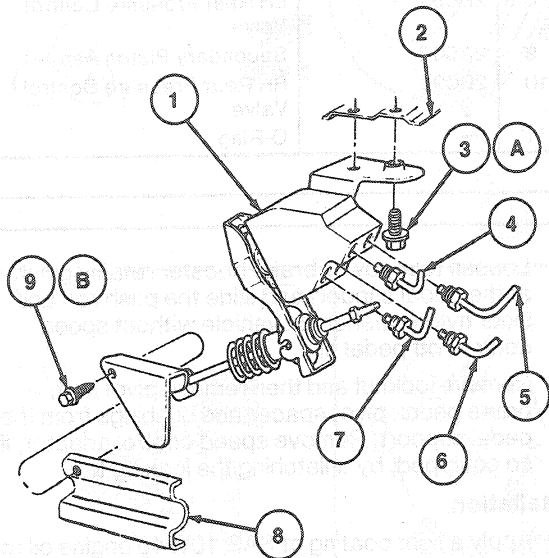

H4007-E

Item	Part Number	Description
1	2B547	Valve Assy
2	—	Body
3A	N802191-S56	Bolt
4	2L568	Brake Tube Assy
5	2L569	Brake Tube Assy
6	2265	Brake Tube Assy
7	2B255	Brake Tube Assy
8	—	Lower Arm
9B	N804846-S56	Bolt
A		Tighten to 11.4-15.6 N-m (8-12 Lb-Ft)
B		Tighten to 6-8 N-m (4-6 Lb-Ft)

Station Wagon

Removal

1. Disconnect primary or secondary brake tube as necessary.
2. Loosen and remove pressure control valve from the master cylinder housing.