

OVERHAUL (Continued)

- Grease parking brake shaft recess and slightly grease parking brake lever shaft. Insert shaft into bore in caliper housing.

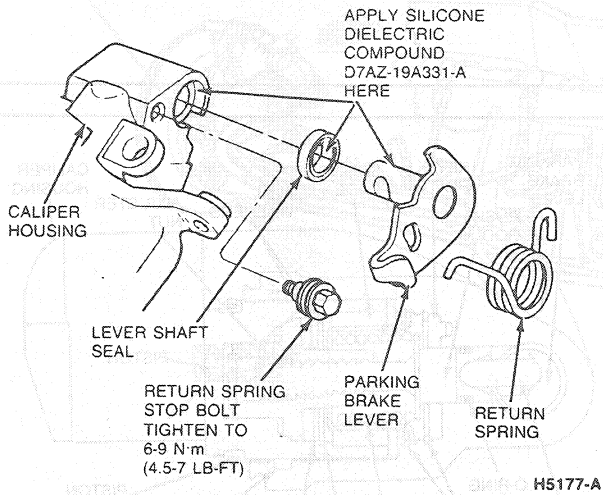

- Screw lever stop bolt into caliper housing. Tighten to 6-9 N·m (4.5-7 lb-ft). Attach parking brake lever return spring to stop bolt and insert free end into parking brake lever slot.
- Install a new O-ring seal in groove of push rod. Grease recess at push rod end with Silicone Dielectric Compound D7AZ-19A331-A (ESE-M1C171-A) or equivalent.
- Position strut pin into caliper housing and in recess of parking brake lever shaft. Insert push rod into push rod bore of caliper housing. Ensure pin is positioned correctly between shaft recess and recess at end of push rod. Place key plate over push rod so that locating nib fits into drilled locating hole in caliper housing. Install flatwasher, push rod, spring and spring cover in order.

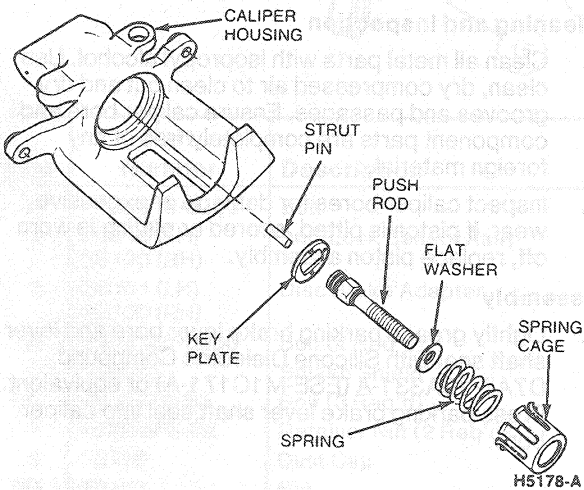

NOTE: Tools used in Steps 6 through 9 are part of Rear Caliper Spring Compressor Set T87P-2588-B.

- Insert outer spacer into piston bore.

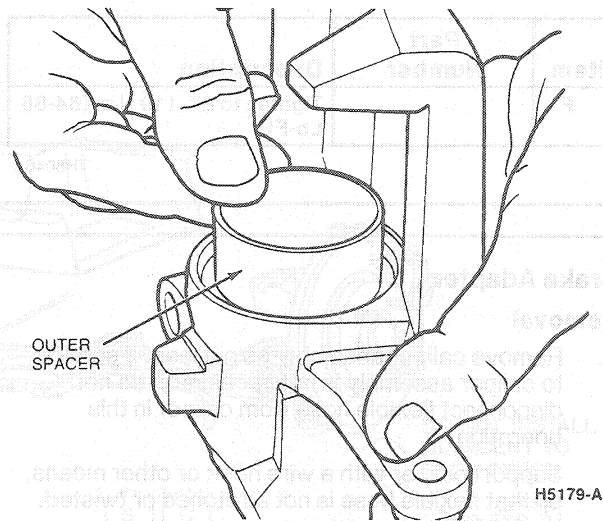

- Insert inner spacer into piston bore.

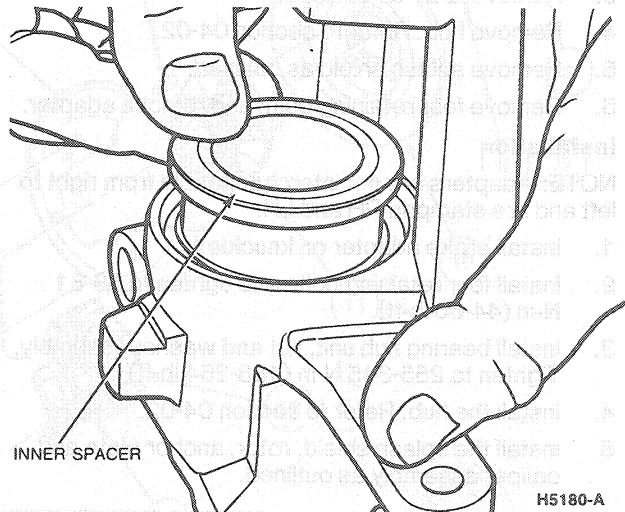

- Place snap ring inside of inner spacer.

