

DISASSEMBLY AND ASSEMBLY (Continued)

NOTE: The tripod assembly cannot be removed from the interconnecting shaft on this design. If a tripod assembly, outer race or interconnecting shaft is required, an inboard side shaft assembly must be used. However, if a boot kit or clamps are required, these are available.

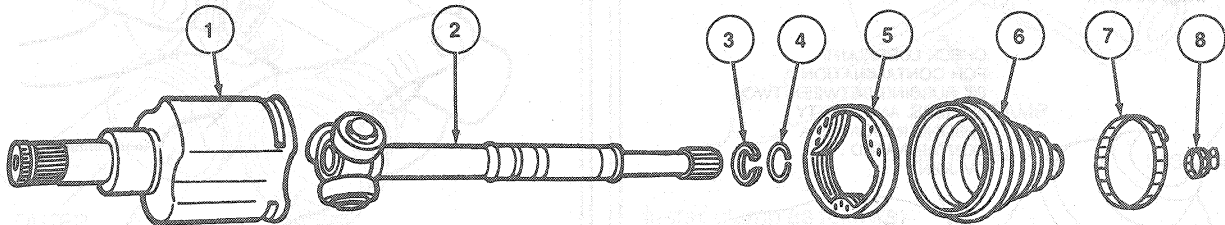

E8636-A

Item	Description
1	Inboard Joint Outer Race and Stub Shaft
2	Interconnecting Shaft Assy
3	Stop Ring

(Continued)

Item	Description
4	Circlip
5	Trilobe Insert
6	Inboard Boot
7	Boot Clamp (Large)
8	Boot Clamp (Small)

CAUTION: On all vehicles (except SHO powertrains), the RH inboard CV joint requires a reusable, low profile boot clamp. A special tool is required to remove and install the clamp. Use Boot Clamp Pliers D87P-1090-A or equivalent.

1. Cut and remove both boot clamps and slide boot back on shaft.

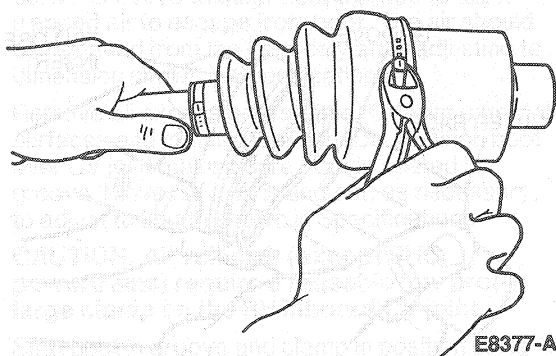

E8377-A

Remove clamp by engaging pincer jaws in closing hooks (A and B) and drawing hooks together. Disengage windows and locking hooks and remove clamp.

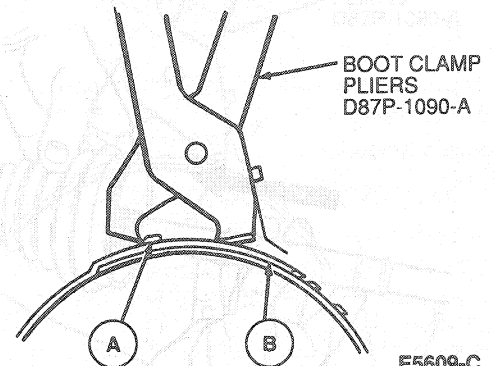

E5609-C

2. Slide outer race off tripod.

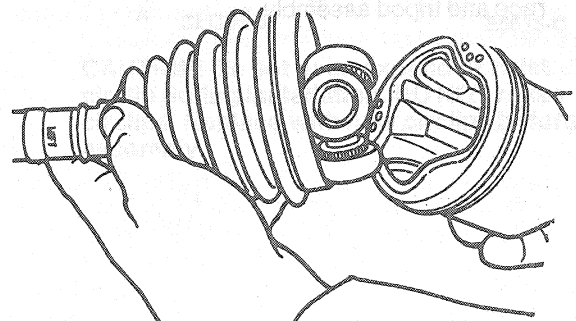

E8367-A