

DESCRIPTION (Continued)

Item	Description
14	Trilobe Insert

Item	Description
15	Inboard Joint Outer Race and Stub Shaft
16	Dust Seal

(Continued)

3.0L WITH ABS,
3.8 AND 3.0L SHO
SHOWN
HALFSHAFTS-
DISASSEMBLED VIEW

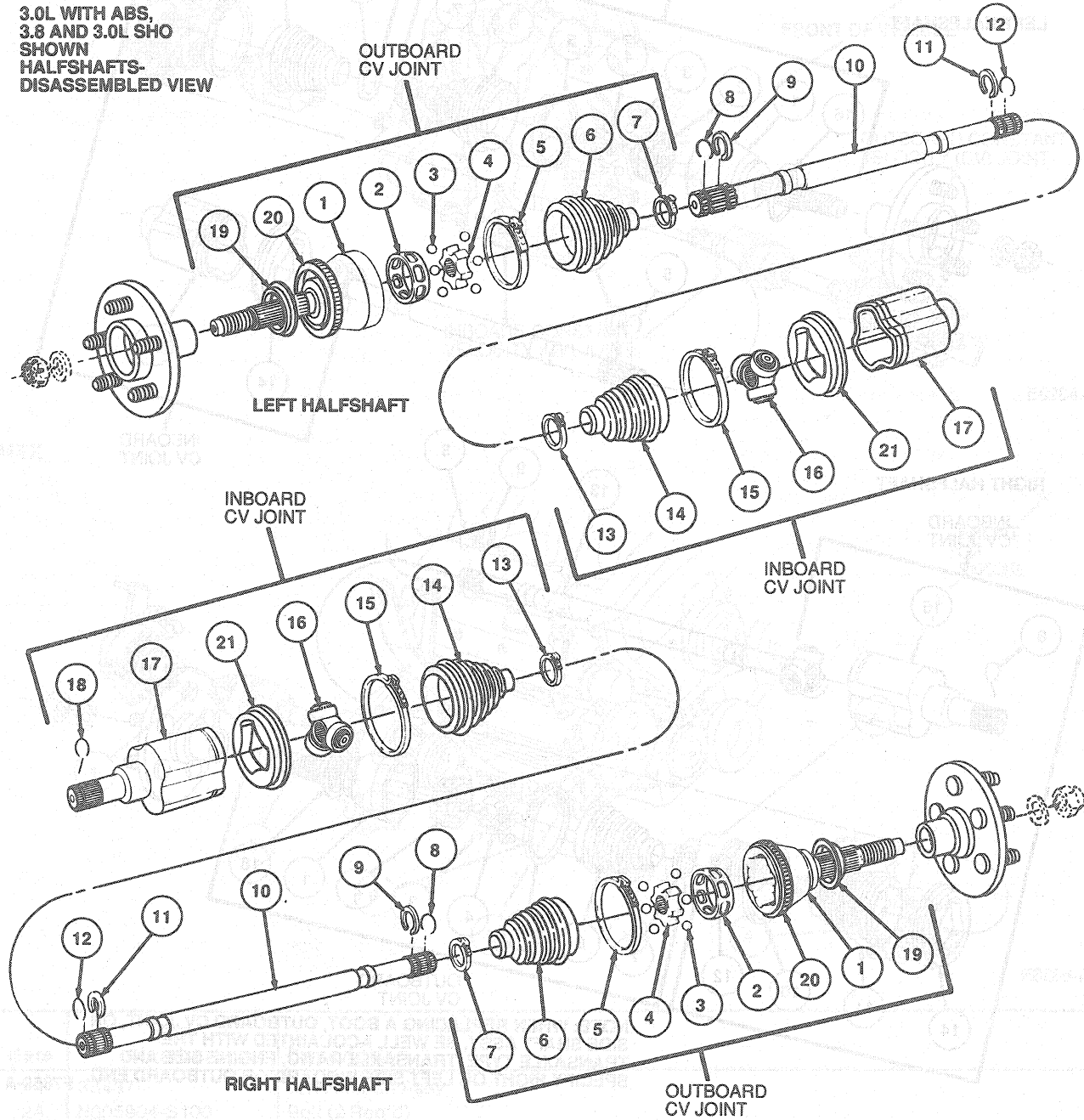

NOTE: WHEN REPLACING A BOOT, CV JOINT, INTERCONNECTING SHAFT, OR COMPLETE HALFSHAFT ASSY, BE WELL ACQUAINTED WITH THE TRANSAXLE TYPE, TRANSAXLE RATIO, ENGINE SIZE AND SPECIFY RIGHT OR LEFT SIDE INBOARD OR OUTBOARD END.

Item	Description
1	Ball Cage
2	Ball (each)
3	Ball Cage
4	Outboard Joint Inner Race
5	Boot Clamp (Large)
6	Boot
7	Interconnecting Shaft
8	Trilobe Insert
9	Boot Clamp (Small)
10	Boot
11	Boot
12	Boot
13	Inboard Joint Outer Race and Stub Shaft
14	Dust Seal
15	Trilobe Insert
16	Trilobe Insert
17	Trilobe Insert
18	Trilobe Insert
19	Trilobe Insert
20	Trilobe Insert
21	Trilobe Insert

(Continued)

(Continued)