

REMOVAL AND INSTALLATION (Continued)

NOTE: The rear control arms have two adjustment cams that fit inside the bushings at the arm-to-body attachment. The cam is installed from the rear on the left arm and from the front on the right arm.

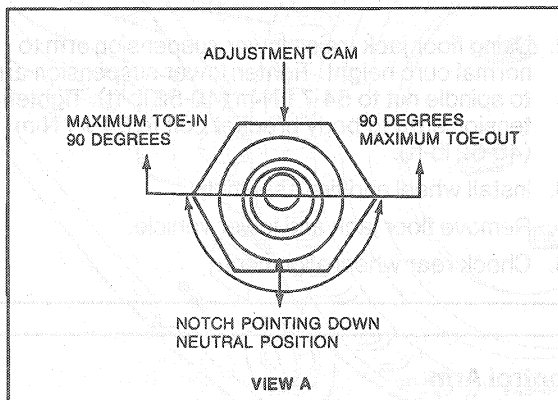
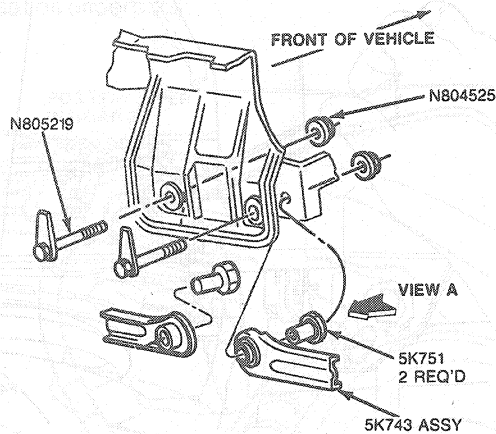

F4382-E

1. Position arm, and cam where required, at center of vehicle. Insert new bolt and nut. **Do not** tighten at this time.
2. Move arm end up to spindle and insert new bolt, washer and nut. Tighten nut to 59.5-80.5 N-m (44-59 lb-ft).
3. Tighten arm-to-body nut to 68-92 N-m (50-67 lb-ft).
4. Install parking brake cable to front arms. Refer to Section 06-05.
5. Install brake proportioning valve to left side front arm. Refer to Section 06-00.
6. Lower vehicle.
7. After control arm replacement, the alignment should be checked for rear toe and reset if required.

Bearing and Hub Assembly, Drum Brakes

Tools Required:

- Coil Remover T89P-19623-FH

Removal

1. Raise vehicle on hoist. Refer to Section 00-02.
2. Remove wheel and tire assembly. Refer to Section 04-04.
3. Remove two pushnuts retaining drum to hub and remove drum.
4. Remove grease cap from bearing and hub assembly and discard cap.
5. Remove hub retaining nut and discard.
6. Remove bearing and hub assembly from spindle.

Installation

1. Position bearing and hub assembly on spindle.
2. Install new hub retaining nut and tighten to 255-345 N-m (188-254 lb-ft).
3. Install new grease cap using Coil Remover T89P-19623-FH. Tap on tool until grease cap is fully seated.
4. Install brake drum on hub. Install two pushnuts that retain drum.
5. Install wheel and tire assembly.
6. Lower vehicle.

Bearing and Hub Assembly, Disc Brakes

Removal

1. Raise vehicle on hoist. Refer to Section 00-02.
2. Remove wheel and tire assembly. Refer to Section 04-04.
3. Remove caliper assembly from brake adapter. Support caliper assembly with a length of wire. Refer to Section 06-04.
4. Remove push on nuts that retain rotor to hub and remove rotor.
5. Remove grease cap from bearing and hub assembly and discard grease cap.
6. Remove bearing and hub assembly retaining nut and discard.
7. Remove bearing and hub assembly from spindle.

Installation

1. Position bearing and hub assembly on spindle.
2. Install new hub retaining nut. Tighten to 255-345 N-m (188-254 lb-ft).
3. Install a new grease cap using Coil Remover T89P-19623-FH. Tap on tool until grease cap is fully seated.
4. Install rotor assembly on hub. Install two push-on nuts that retain rotor.
5. Install caliper assembly to brake adapter.