

DESCRIPTION (Continued)

Item	Part Number	Description
1	5494	Stabilizer Bar
2A	N803990-S160	Bolt (2 Req'd)
3A	N800237-S101	Nut (4 Req'd)
4	N804350-S1036	Washer (2 Req'd)
5	N805708-S7	Washer (2 Req'd)
6	3468	Tension Strut (2 Req'd)
7	N805480-S160	Nut (2 Req'd)
8B	N804608-S150	Nut (2 Req'd)
9	N804002-S100	Washer (2 Req'd)
10	18183	Strut Mount Assy (2 Req'd)
11	N806779-S100	Washer (2 Req'd)
12	18045	Strut Assy
13	3K028	Bearing and Seat Assy (2 Req'd)
14C	N803826-S150	Nut (6 Req'd)
15	N804018-S36M	Flat Washer (Except SHO/MTX and Police) (2 Req'd)
16	N805627-S36M	Cupped Washer (SHO/MTX and Police) (2 Req'd)
17	—	Subframe
18	3C078	Bushing Insulator (Red—SHO/MTX and Police) (2 Req'd)

(Continued)

Item	Part Number	Description
19	3C067	Bushing Assy (2 Req'd)
20	3B438	Link Assy (2 Req'd)
21D	N804911-S160	Nut (2 Req'd)
22C	N806899-S7	Bolt (4 Req'd)
23	5486	U-Bracket (2 Req'd)
24	5484	Insulator (2 Req'd)
25E	N804446-S160	Nut (2 Req'd)
26	3K185 RH 3K186 LH	Knuckle Assy
27B	N803985-S160	Nut (2 Req'd)
28	3051 LH 3042 RH	Control Arm Assy
29	N804021-S160	Bolt (2 Req'd)
30A	N803989-S160	Bolt (2 Req'd)
31	1104	Hub Assy
A		Tighten to 98-132 N·m (73-97 Lb·Ft)
B		Tighten to 53-72 N·m (40-53 Lb·Ft)
C		Tighten to 30-40 N·m (23-29 Lb·Ft)
D		Tighten to 77-103 N·m (57-75 Lb·Ft)
E		Tighten to 47-63 N·m (35-46 Lb·Ft)

Wheel Assembly

Each front wheel is bolted to a hub assembly. There are two opposed tapered roller bearings (inner and outer) with grease retainer seals (inner and outer), encased in one single cup or cartridge. This bearing assembly is pressed into the steering knuckle bore from the inboard side until it rests against the shoulder on the outboard side. A snap ring is installed in a groove on the inboard side of the knuckle bore for added bearing retention. A bearing dust seal is installed on the constant velocity (CV) joint, inboard of the knuckle/bearing/hub assembly. The hub assembly is pressed into the bearing/knuckle assembly. The CV joint splined shaft is pressed through the hub. A prevailing torque hub nut and washer retain the hub assembly to the CV joint.

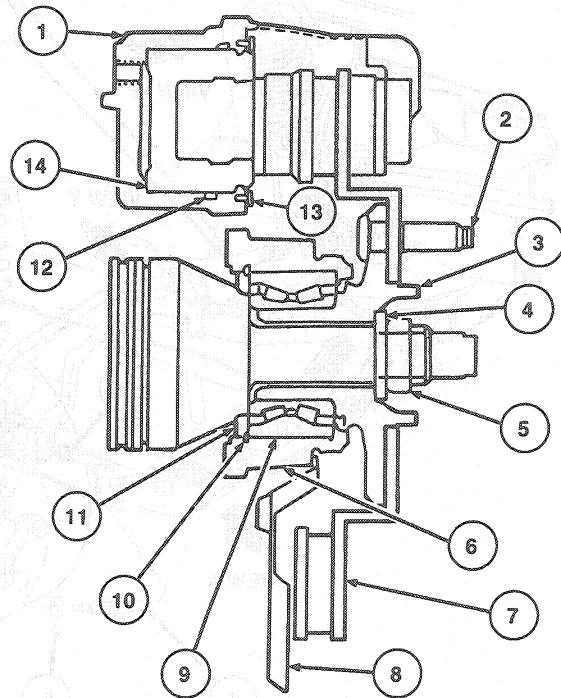

F7655-A