

REMOVAL AND INSTALLATION (Continued)

REMOVAL AND INSTALLATION (Continued)

3.0L Engine

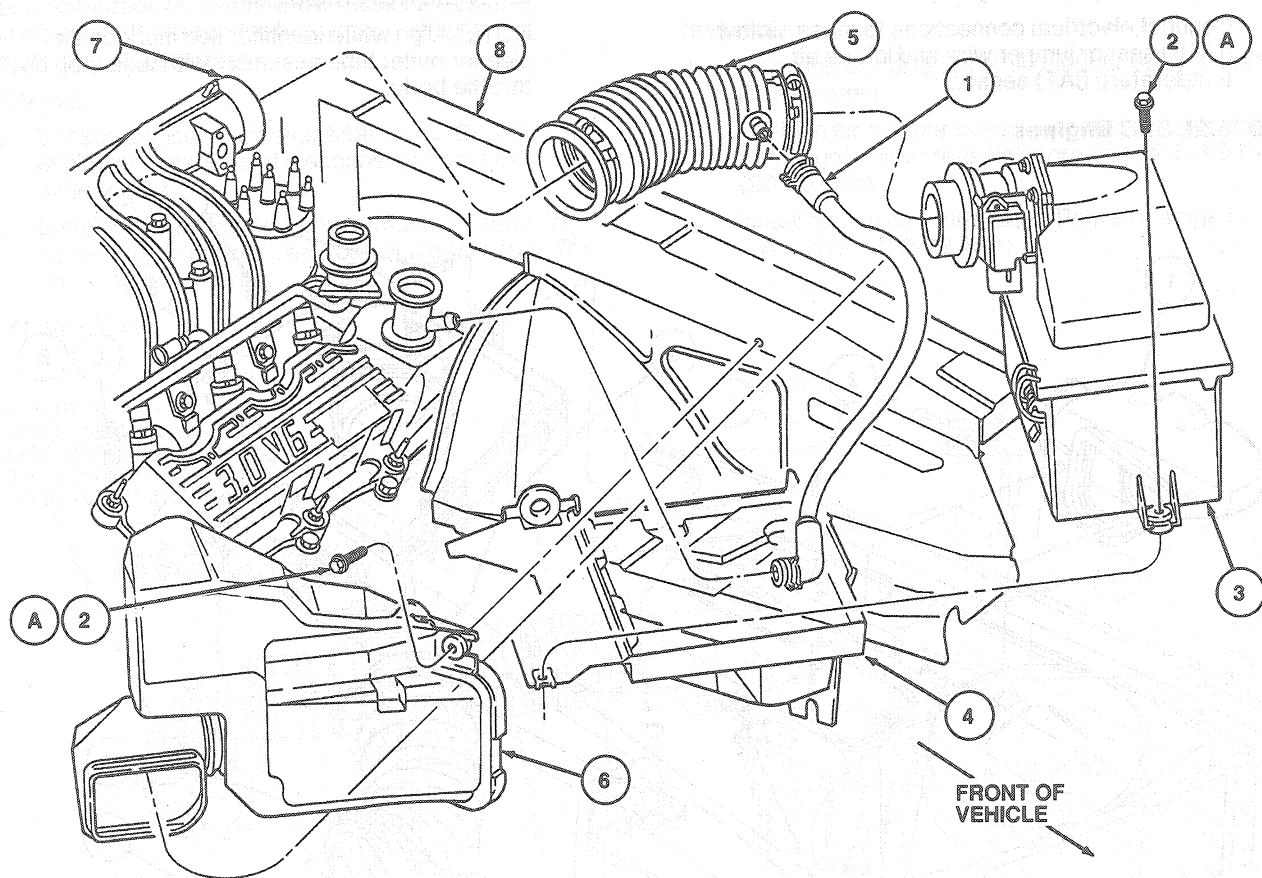

V7422-C

Item	Part Number	Description
1	6C342	Hose Assy
2A	806215-S141B	Screw (2 Req'd)
3	9600	Engine Air Cleaner
4	10732	Battery Tray

(Continued)

Item	Part Number	Description
5	9B659	Air Cleaner Outlet Tube
6	9F763	Engine Air Intake Resonator
7	—	Manifold Assy
8	—	LH Fender Apron
A	—	Tighten to 2.7-5.4 N-m (24-47 Lb-in)

3.0/3.2L SHO Engine

Removal

- Loosen air cleaner outlet tube clamp and disconnect air cleaner outlet tube.
- Disconnect electrical connections at MAF sensor jumper wire and intake air temperature (IAT) sensor 12A697.
- Remove air cleaner retaining screws and remove engine air cleaner from vehicle.
- Inspect inside surfaces of cover for traces of dirt leakage past element as a result of damaged element seals, wrong element usage, or inadequate tension on cover retaining clips.

- Remove air cleaner element and clean sealing surfaces on tray and cover. Inspect new element for possible damage in handling such as deformed seals or holes in paper.

Installation

NOTE: The air cleaner assembly mounting tab must be engaged with the battery tray grommet boss.

- Install a new element.
- Position engine air cleaner to engine compartment side panel. Ensure that mounting grommet is installed with metal side up and battery tray grommet is fully seated in battery tray. Check air cleaner cover hinge assembly. Secure retaining clips.