

REMOVAL AND INSTALLATION (Continued)

REMOVAL AND INSTALLATION (Continued)

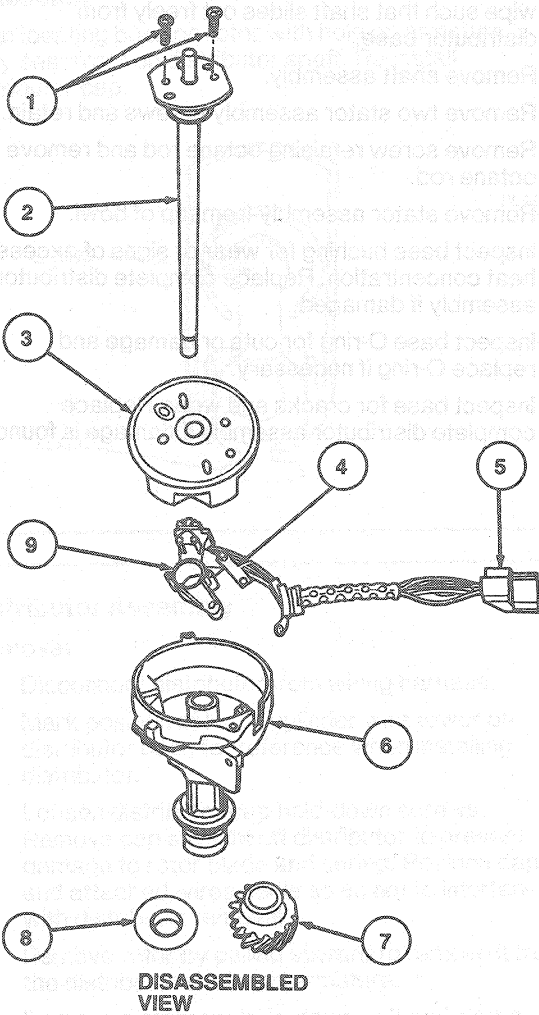

DISASSEMBLED VIEW

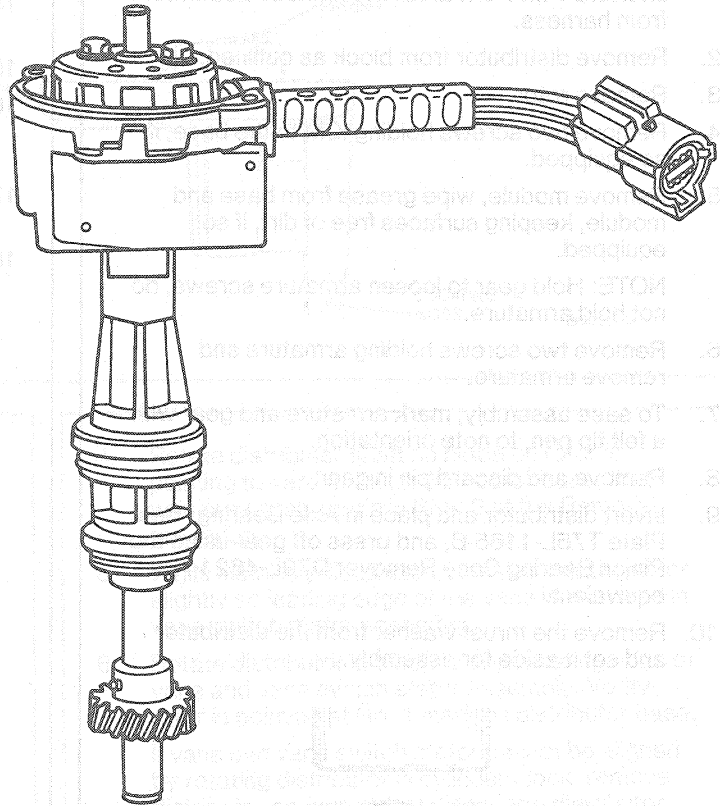

ASSEMBLED VIEW 3.8L

B4409-C

Item	Part Number	Description
1	—	Screws (2 Req'd)
2	—	Shaft Assy
3	—	Rotary Vane
4	—	Octane Rod

(Continued)

Item	Part Number	Description
5	—	Connector
6	—	Base Assy
7	—	Gear
8	—	Collar
9	—	Hall Effect Vane Stator Switch Assy

Installation

1. Place stator assembly over bushing and press down to seat.
2. Place stator connector in position. Tab should fit in notch on base and fastening eyelets aligned with screw holes.
3. Position wires away from moving parts.
4. Install two stator screws and tighten to 1.7-4.0 N-m (15-35 lb-in).

5. Install octane rod and retaining screw. Tighten to 1.7-4.0 N-m (15-35 lb-in).
6. Apply a light coat of Motor Oil XO-10W30-QSP (ESE-M2C 153-E) or equivalent, to distributor shaft below armature.
7. Insert shaft through base bushing.
8. Place a 1/2-inch deep well socket over shaft, invert and place on arbor plate.