

DISASSEMBLY AND ASSEMBLY (Continued)

Starter Motor—Exploded View

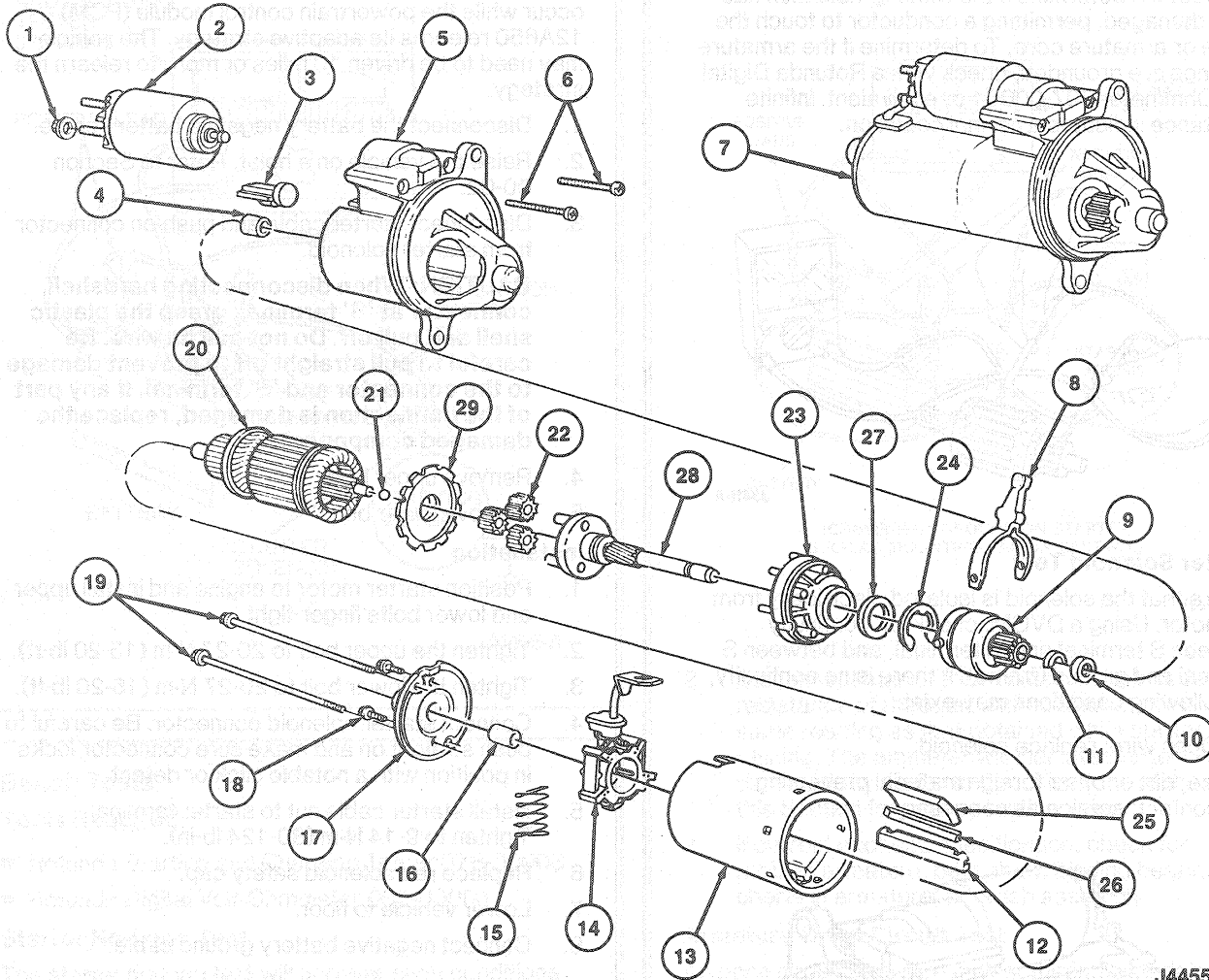

J4455-A

Item	Part Number	Description
1	N805403	Terminal Nut
2	11390	Starter Solenoid
3	11A171	Housing Seal Assy
4	11135	Bushing Bearing
5	11130	Drive End Housing
6	N805405	Solenoid Screw (2 Req'd)
7	11000	Starter Motor Assy
8	11070	Drive Lever
9	11350	Drive Assy
10	11223	Stop Ring Retainer
11	11222	Stop Ring
12	11A169	Magnet Retainer (6 Req'd)
13	11076	Shaft Frame
14	11434	Brush Assy
15	11059	Spring

Item	Part Number	Description
16	11135	Bushing Bearing
17	11050	Brush End Plate
18	N805406	Brush Plate Screw (2 Req'd)
19	N805428	Through-Bolt (2 Req'd)
20	11005	Armature Assy
21	11A172	Armature Thrust Ball
22	11K190	Planet Gear
23	11A165	Stationary Gear Assy
24	N805404	Truarc E-Ring
25	11A168	Magnet Pole Piece (6 Req'd)
26	11A161	Pole Shunt (6 Req'd)
27	11A075	Armature
28	11A160	Shaft Assy
29	11A167	Gear Retainer

TJ4455A

(Continued)