

## REMOVAL AND INSTALLATION (Continued)

- Install throttle body with new air charge control to intake manifold gasket on the four studs of the upper intake manifold. Tighten retaining nuts to 25 N·m (19 lb-ft).
- Connect throttle position sensor and idle air control (IAC) valve.

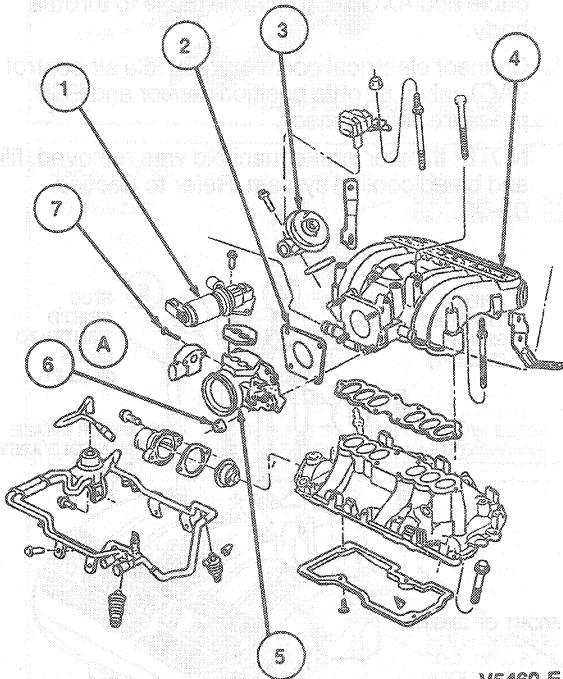

V5460-E

Item	Part Number	Description
1	9F715	Idle Air Control Valve
2	9E936	Air Charge Control to Intake Manifold Gasket
3	9D475	EGR Valve
4	9424	Upper Intake Manifold
5	9E926	Throttle Body
6A	—	Nut
7	N603257-S100	Screw
A		Tighten to 25 N·m (19 Lb-Ft)

TV5460E

## Throttle Position (TP) Sensor

## Removal

- Disconnect throttle position sensor from wiring harness.
- Scribe a reference mark across the edge of the sensor and to the throttle body to ensure correct position during installation.
- Remove two throttle position sensor retaining screws.
- Remove throttle position sensor.

3 Can be purchased as a separate item.

## Installation

- To install throttle position sensor, reverse Removal procedure.
- Tighten retaining screws to 2.4-3.8 N·m (21-34 lb-in).
- If required, adjust throttle position sensor, refer to the Powertrain Control/Emissions Diagnosis Manual<sup>3</sup>.

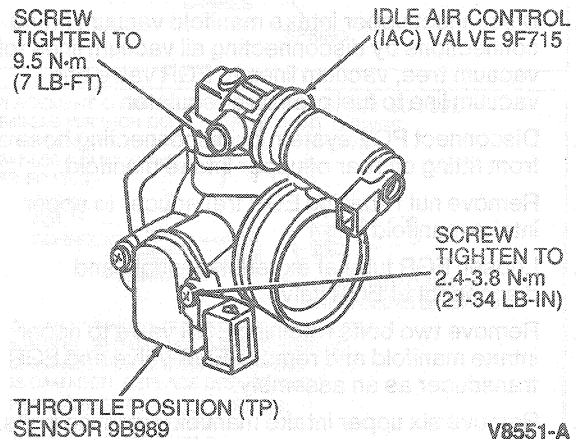

## Idle Air Control (IAC) Valve Assembly

## Removal

- Disconnect the idle air control valve assembly connector from the wiring harness.
- Remove the two idle air control (IAC) valve retaining screws.
- Remove the idle air control (IAC) valve and gasket.

## Installation

- Clean gasket mating surfaces.  
NOTE: If scraping is necessary, be careful not to damage idle air control (IAC) valve or throttle body gasket surfaces, or drop material into throttle body.
- To install valve, reverse Removal procedure.
- Tighten retaining screws to 9.5 N·m (7 lb-ft).

## Fuel Rail Assembly

## Tools Required:

- Spring Lock Coupling Disconnect Tool D87L-9280-A (3/8 inch) or D87L-9280-B (1/2 inch)

## Removal

- Perform Steps 1 through 4 under Fuel Charging Assembly, Pre-Service Procedures.