

## DISASSEMBLY AND ASSEMBLY (Continued)

3. Install distributor clamp assembly and tighten to 27-40 N·m (20-29 lb-ft).

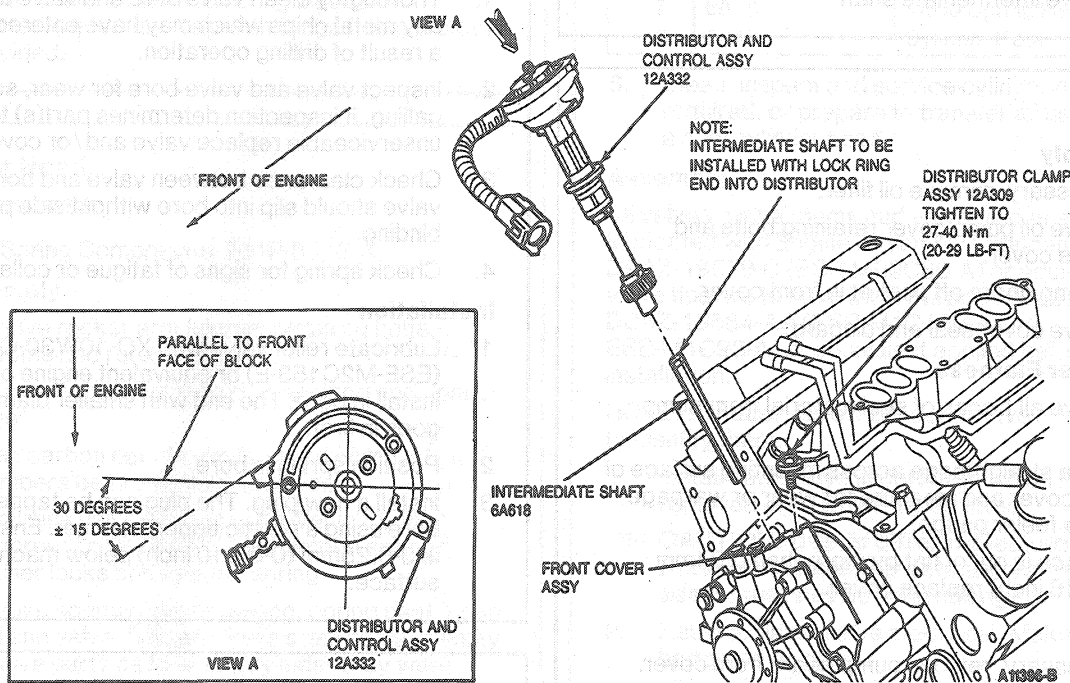

## Spark Plug Thread Service

## Tools Required:

- Rotunda Tapersert Installation Kit 107-00901

Damaged spark plug threads in the cylinder head can be serviced using Rotunda Tapersert Installation Kit 107-00901 or equivalent.

**NOTE:** The use of power or air driven tools is not approved for the installation of taperserts.

The procedure involves cutting new threads in the spark plug hole. After rethreading operation, a tapered sleeve will be installed in the head. The sleeve is threaded on the inside and outside. The outside threads into the cylinder head while the inside provides new threads for the spark plug.

This service is permanent and will have no effect on cylinder head or spark plug life.

**CAUTION:** The cylinder head must be removed from engine before installing a tapersert. The service procedure includes a thread cutting process which produces metal chips. Performing this procedure while the cylinder head is on the engine will cause metal chips to fall into the cylinder. Once in the cylinder, these chips can damage the cylinder wall when the engine is started.

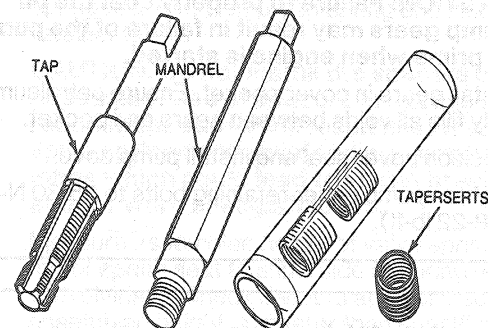

1. Thoroughly clean spark plug counter bore, seat and threads of all dirt or other foreign material.
2. Start tap into spark plug hole being careful to keep it properly aligned.

As tap begins cutting new threads, apply aluminum cutting oil to tap.

Continue cutting threads and applying oil until stop ring bottoms against spark plug seat.

3. Remove tap. Remove all metal chips using compressed air.