

REMOVAL AND INSTALLATION (Continued)

8. Install lower engine / flywheel dust cover to the converter housing.
9. Install catalyst and pipe assembly. Connect HO2S's.
10. Install starter motor. Refer to Section 03-06.
11. Install low oil level sensor connector to the sensor and install retainer clip.
12. Lower vehicle.
13. Install accessory drive belts. Refer to Section 03-05.
14. Replace oil level dipstick.
15. Connect battery ground cable.
16. Fill crankcase with the correct viscosity and amount of engine oil.
17. Start engine and check for engine oil and exhaust leaks.

Sensors

Removal

Unless otherwise noted, all sensors are removed by disconnecting wiring connector and unscrewing sensor. Refer to Section 18-01 for electrical connector disengagement.

Differential Pressure Feedback EGR (DPFE) 3.2L SHO Only

Located in the rear of the intake manifold. When installing, tighten to 15-23 N·m (11-17 lb-ft). Sensor is retained by two screws to intake manifold. When installing, tighten to 2-3 N·m (18-27 lb-in).

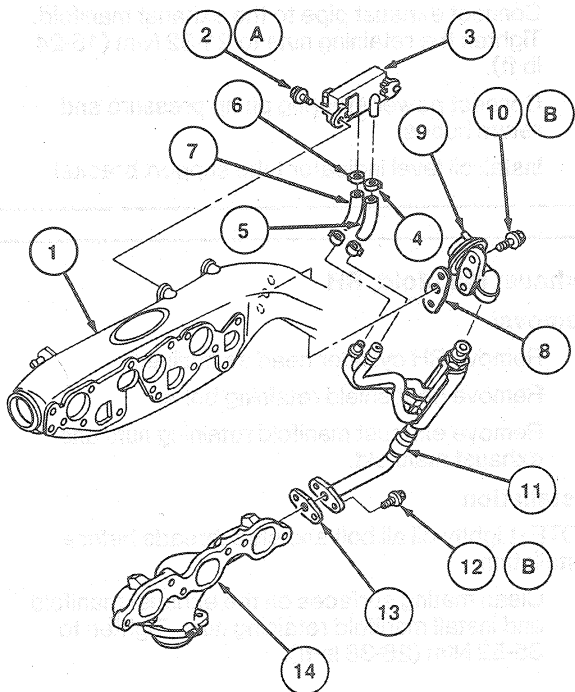

A12896-B

Item	Part Number	Description
1	9424	Upper Intake Manifold
2A	—	Screw (2 Req'd)
3	9J433	EGR Transducer
4	—	Clamp (2 Req'd)
5	—	Hose
6	—	Clamp (2 Req'd)
7	—	Hose
8	9D476	EGR Valve Gasket
9	9D475	EGR Valve
10A	90119-08151	Bolt (2 Req'd)
11	9D477	EGR Valve to Exhaust Manifold Tube
12A	90119-08146	Bolt (2 Req'd)
13	9F470	EGR Cooler Tube Inlet Gasket
14	9430	Exhaust Manifold
A		Tighten to 2-3 N·m (18-27 Lb-in)
B		Tighten to 15-23 N·m (11-17 Lb-Ft)

Engine Coolant Temperature (ECT) Sensor 12A648

Located at the rear of the intake manifold to the rear of the throttle body. When installing, tighten to 16-24 N·m (12-17 lb-ft).

Knock Sensor (KS) 12A699

Located under the intake manifold and fuel rails. When installing, tighten to 29-39 N·m (21-29 lb-ft).

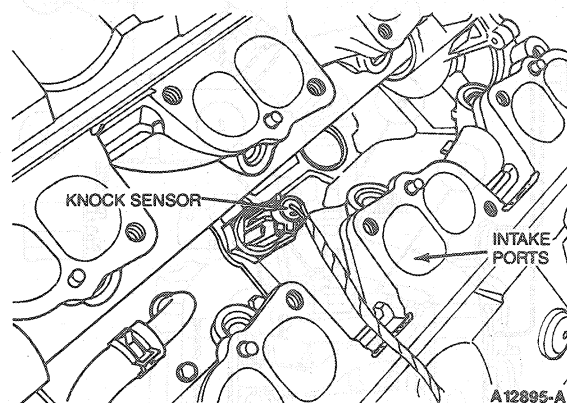

Oil Level Sensor

Located in the oil pan. When installing, tighten to 21-33 N·m (15-24 lb-ft).

Oil Pressure Sending Switch

Located in the right rear face of cylinder block. When installing, tighten to 16-24 N·m (12-18 lb-ft).