

REMOVAL AND INSTALLATION (Continued)

Bumper, Rear—Wagon

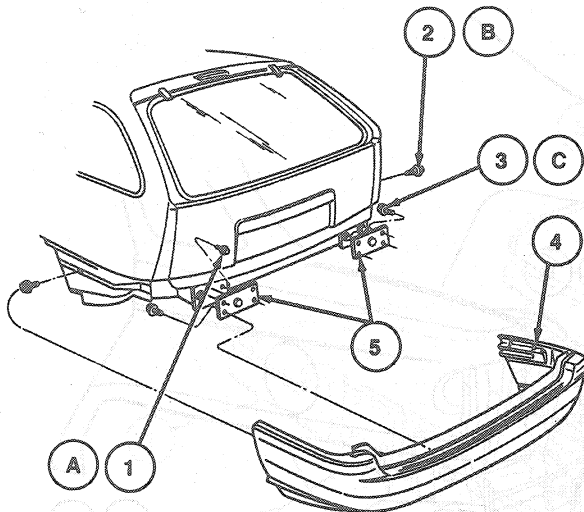

N6646-E

Item	Part Number	Description
1A	N606702-S2	Screw and Washer Assy (2 Req'd)
2B	N804984-S100	Screw and Washer (1 Req'd Each Side)
3C	N805433-S54	Piloted Screw and Washer (3 Req'd Each Side)
4	17775 AW (Taurus) 17775 BW (Sable)	Rear Bumper Assy
5	17D788 (RH) 17D864 (LH)	Rear Isolator and Bracket Assy
A		Tighten to 35-55 N·m (26-40 Lb·Ft)
B		Tighten to 9.5-15 N·m (8-11 Lb·Ft)
C		Tighten to 22-34 N·m (16-25 Lb·Ft)

Bumper, Front and Rear

CAUTION: Never apply heat to the bumper energy absorber. Heat could cause the material inside the absorbers to expand and flow out of the absorbers or crack the metal housing. Always remove the absorbers before making body frame service near them.

Removal

1. Remove bolts retaining bumper to isolator and bracket assemblies. Disconnect and remove fog lamps or front cornering lamps, if so equipped. On SHO vehicles, remove front bumper cover assembly as outlined.
2. Slide bumper off screw and washer assemblies mounted on front fender (or quarter panel for rear bumper removal).

Installation

NOTE: Only the attaching hardware shown may be used. Do not substitute any other parts or finishes for those specified.

The Taurus valance panel is secured to the front bumper with 10 push pins. The Sable valance panel is secured to the front bumper with eight push pins on the bottom.

1. If the bumper is to be replaced, assemble valance panel for front bumpers and paint new bumper. Assemble step pad and stone deflector for Station Wagon rear bumper. Assemble front cornering lamps, if so equipped.
2. To install Station Wagon rear bumper step pad, starting at center of pad, carefully align attaching tabs to bumper and impact pad surface with rubber mallet.
3. Slide bumper onto screw and washer assemblies mounted on front fender (or quarter panel). Install front cornering lamp sockets, if so equipped.
4. Position bumper to isolators and install retaining bolts. Refer to the following illustrations for Adjustments.
5. Tighten isolator-to-bumper bolts to 22-34 N·m (17-25 lb-ft).