

REMOVAL AND INSTALLATION (Continued)

Sable

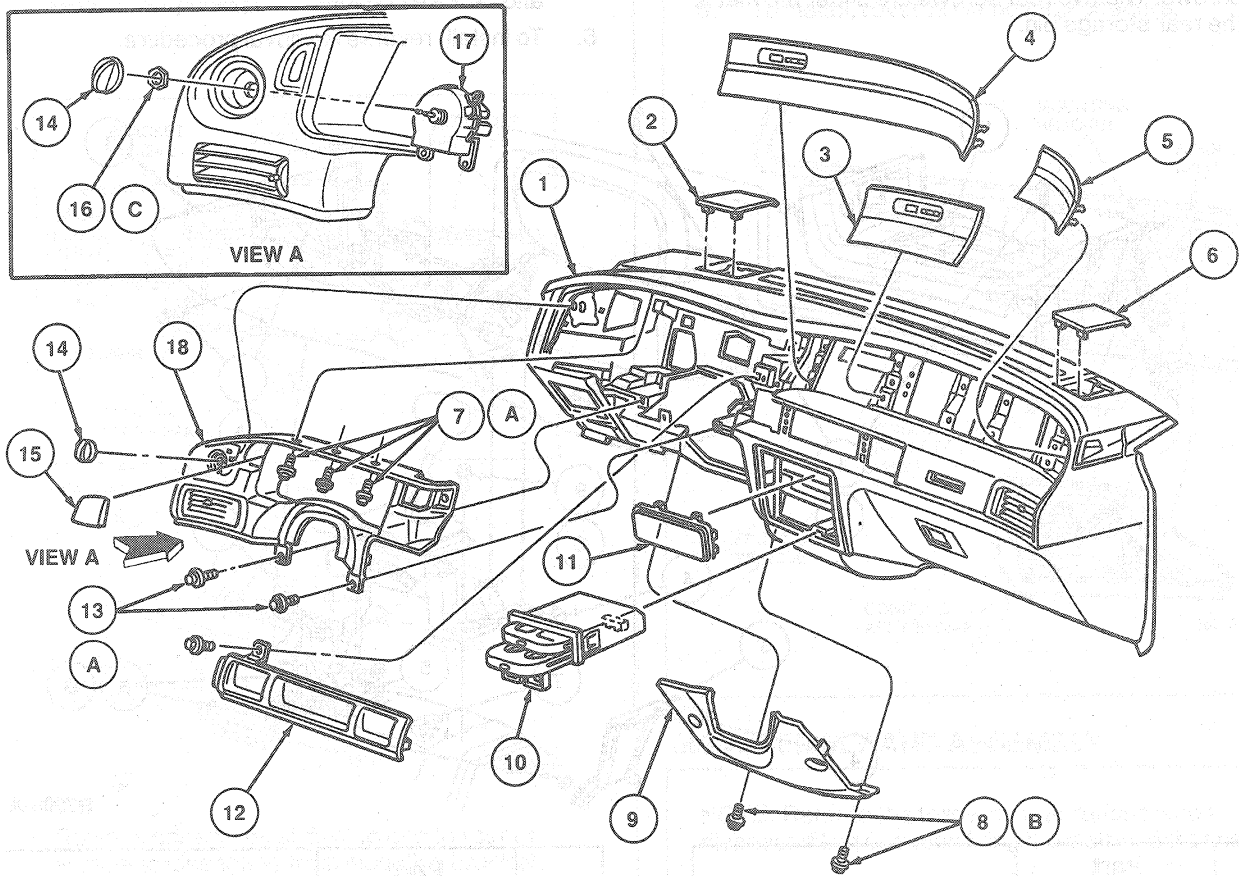

R7619-B

Item	Part Number	Description
1	4304	Instrument Panel Assy
2	45G11	LH Quarter Finish Panel
3	44A91	LH Finish Panel (With Air Bag)
4	44B78	RH Finish Panel (Without Air Bag)
5	44A90	RH Finish Panel (With Air Bag)
6	45G10	RH Quarter Finish Panel
7A	N804306-S36B	Screw (3 Req'd)
8B	N806715-S36B	Screw (4 Req'd)
9	46A72	Cover and Pad Steering Column Opening
10	6202A	Utility Tray

(Continued)

Item	Part Number	Description
11	4371	Instrument Panel Radio Opening Cover
12	44A92	Center Finish Panel
13A	N804306-S36B	Screw (3 Req'd)
14	11666	Light Switch Knob Assy
15	44F58	Instrument Panel Control Opening Cover
16C	N803442-S36	Light Switch Nut
17	11654	Headlamp Switch Assy
18	44D70	Instrument Panel Cluster Opening Panel Assy
A		Tighten to 2-3 N·m (18-26 Lb·In)
B		Tighten to 9-14 N·m (80-123 Lb·In)
C		Tighten to 6-8 N·m (53-71 Lb·In)

Console Assembly, Floor

Removal and Installation

1. Remove cupholder and shift lever opening cover retaining screw.

2. Move shift lever rearward.
3. Remove shift lever opening cover (snaps out).